

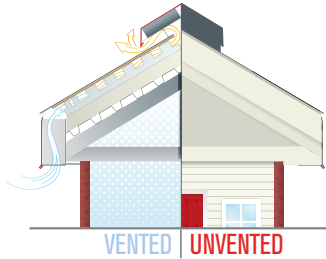

# Techni-Flo® RV

## Engineered Ridge Vent

**DESCRIPTION:** The Techni-Flo® RV accommodates both standing seam and shingled roof applications, and is engineered to individual job requirements. Featuring a snap on cover for ease of installation, this all-metal ridge vent can withstand heavy snow-loads, and will not compress under stress. It also features slotted fastening holes for proper thermal movement and correct fastener placement.



The Techni-Flo® RV is just one part of the Techni-Flo® Engineered Ventilation system. When combined with the Techni-Flo® EV and ACFoam® CrossVent and Atlas® Nail Base Fasteners, it creates a state-of-the-art ventilation system specifically designed to create consistent air intake and exhaust under the roof covering. Properly designed and engineered ventilation through the roof system is essential for roof system durability in both commercial and residential steeped-sloped roofing systems.

### FEATURES & Sizing and Materials

- BENEFITS:**
- Engineered and fabricated to individual job requirements
  - Cover is available in .40", .50", and .63" aluminum and 24 ga. steel
  - Accommodates both standing seam and shingled roofs
  - Custom colors available

### Efficient Design

- Easy snap-on cover
- All metal construction withstands heavy snow loads and will not compress under stress
- Designed to allow shingle attachment
- Slotted fastening holes for proper thermal movement and correct fastener placement and spacing
- Manufactured in 12' lengths – fewer splice joints
- Passed wind-driven rain test

### Comprehensive Warranty

- Ridge and eave vents will withstand winds up to 130mph when installed and utilized in accordance with recommended guidelines\*\*
- Vents will be manufactured free of any defects
- Finish will not fade or crack. Covers repair or replacement of the ridge and eave for 20 years
- Vents will continue to provide designed ventilation for the duration of the warranty\*

\*See the warranty for terms and conditions

Techni-Flo® EV is not intended for attachment to open ended metal truss or metal bar joist applications.

\*\*Design enhancements required for 130 mph wind speed coverage include, but are not limited to a minimum .050" aluminum or .063" aluminum cover.

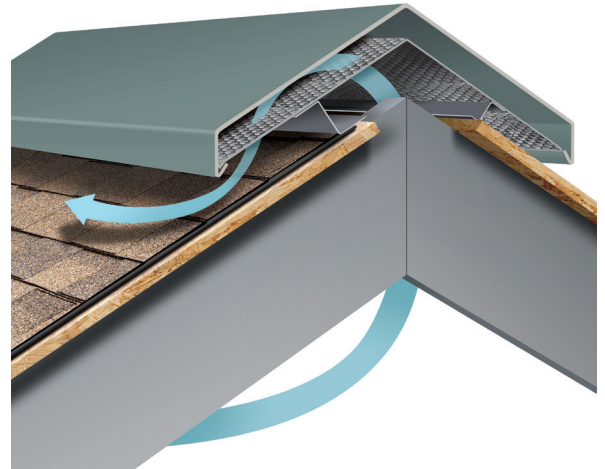

The image above Techni-Flo® RV depicts the different parts that make up the RV product. Proper installation is required to achieve optimal airflow through the eave. Go to [www.atlasroofing.com](http://www.atlasroofing.com) for further installation instructions.

### OTHER PRODUCTS IN THE TECHNI-FLO® ENGINEERED VENTILATION SYSTEM:

#### ■ ACFoam® CrossVent

Cross Ventilating nailable polyiso insulation.

#### ■ ACFoam®-Nail Base Fastner

Nailable Insulation Fastener.

#### ■ Techni-Flo® EV

Engineered Eave Vent designed to create continuous intake for maximum airflow.

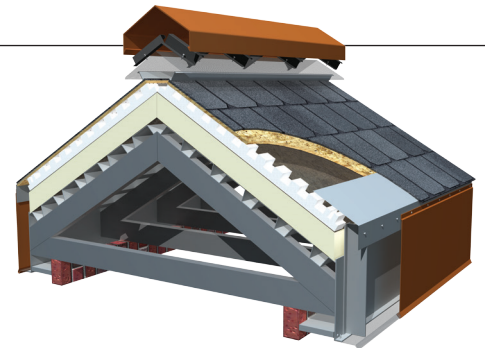

Other than the aforementioned representations and descriptions, Atlas Roofing Corporation (hereafter, "Seller") makes no other representations or warranties as to the insulation sold herein. The Seller disclaims all other warranties, express or implied, including the warranty of merchantability and the warranty of fitness for a particular purpose. Seller does, however, have a limited warranty as to the LTR-Value of the insulation, the terms of which are available upon request from the Seller. Seller shall not be liable for any incidental or consequential damages including but not limited to the cost of installation, removal, repair or replacement of this product. Buyer's remedies shall be limited exclusively to, at Seller's option, the repayment of the purchase price or resupply of product manufactured by Atlas in a quantity equal to that of the nonconforming product. Atlas distributors, agents, salespersons or other independent representatives have no authority to waive or alter the above limitation of liability and remedies.

