

REFERENCE DETAIL:

TECHNI-FLO RV

SLOPE TO SLOPE, SHINGLED VERSION

U.S. PATENT # 8,075,376 B1



ACTUAL LINEAL FOOTAGE OF RIDGE



ACTUAL LINEAL FOOTAGE OF EAVE

ALL FASTENERS BY OTHERS

.050 (1.27 mm) EXPANDED METAL SUPPORT SCREEN

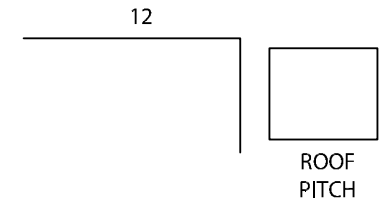

ENDCAPS

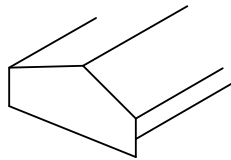

STYLE A

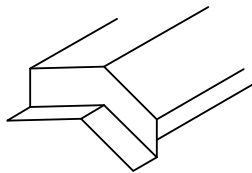

STYLE B



CONTINUOUS 20 GA. (1.01 mm) GALV. Z BRACKET



FASCIA IS TO BE INSTALLED PER SPECIFICATIONS AND ATLAS ROOFING'S INSTALLATION INSTRUCTIONS DWG. # 38124-14981

Fabrication will proceed only after receipt of signed print approval.

Print Approval:

Architect and/or contractor shall verify all dimensions, sizes and quantities. All products to be installed in strict accordance with Atlas Roofing's printed instructions.

Approved by: _____

Date: _____

CrossVent:

Vented Nailbase _____ Air Space

COVER:

- 24 Ga. (.65 mm) Galv. Steel
- .040" (1.01 mm) Aluminum
- .050" (1.27 mm) Aluminum
- .063" (1.60 mm) Aluminum
- Other _____

Color: _____ Finish: _____

PROJECT:

ARCHITECT:

CONTRACTOR:

REPRESENTATIVE:

QUANTITIES:

_____ Lineal Feet (12'-0" (3.65 m) Lengths)

_____ End Cap (12" (305 mm) Lengths)

_____ Style A _____ Style B



Phone: 855-542-0918
Fax: 800-770-3934
roof.atlasroofing.com

DATE: 02/06/12

SHT.# ____ OF ____

DRN BY: JJC

CKD BY: SAK

DWG# 38024-14793

B