

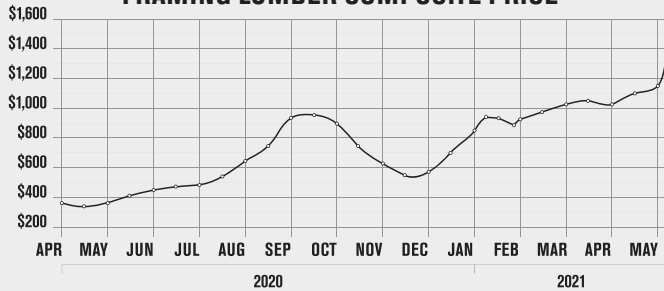

Atlas EnergyShield® Continuous Wall Insulation can replace OSB sheathing while meeting building codes, saving money and providing a more energy-efficient home to the homeowner. Polyiso continuous insulation can be paired with alternative bracing methods, such as corner bracing and metal strapping, to eliminate much of the OSB sheathing depending on the size and shape of the house.

“Lumber prices have skyrocketed more than 250% since last spring... causing the average new single-family home to increase by more than \$35,000 since April 17, 2020.”¹

FRAMING LUMBER COMPOSITE PRICE



Prices shown are averages based on data from multiple industry sources. Graph is for illustration purposes only.

POLYISO CI SHEATHING WITH METAL LET-IN T-BRACING

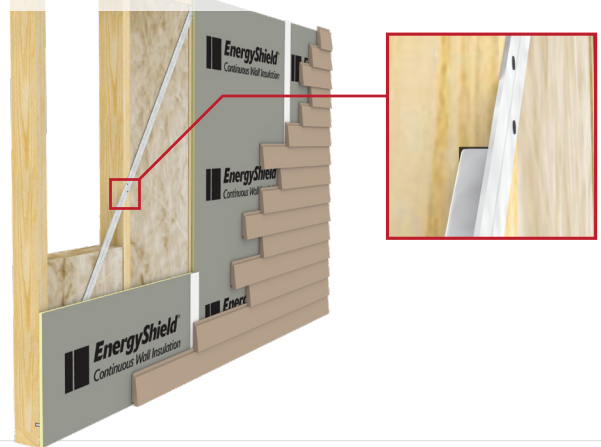

Rendering is for illustration purposes only.

The Polyiso Advantage



Cost: As of April 2021, the price of OSB soared to \$1,200 per thousand square feet.² EnergyShield Continuous Wall Insulation is currently under \$450 per thousand square feet (based on 1/2" thickness).

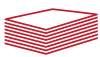

Availability: Unlike OSB, polyiso insulation has optimal supply availability, meaning builders can receive orders on time to keep strict construction schedules moving forward.



R-value: Polyiso insulation achieves a higher effective R-value with minimal material thickness and significantly reduces thermal bridging, meaning homeowners can have a more energy-efficient home.



Weather-Resistant Barrier (WRB): Polyiso insulation is an approved WRB³ in place of an additional, traditional WRB membrane, meeting building codes.

Bracing for Change

Common and approved methods of bracing can be found in the 2018 IRC, Section R602.10 and are based on equivalent performance.⁴ This means structural performance of using alternative bracing with polyiso can be just as strong as using OSB sheathing, as long as the minimum requirements are met.

The Advanced Alternative

By making straightforward adjustments to building plans in replacing OSB with polyiso and bracing methods, builders can save significant time and money. When combined with the added benefits of polyiso insulation, including higher R-values and WRB capabilities, the advantages are clear.

¹ <https://nahbnow.com/2021/04/skyrocketing-lumber-prices-add-nearly-36000-to-the-price-of-a-new-home/>

² <https://fortune.com/2021/03/20/lumber-prices-2021-chart-when-will-wood-shortage-end-price-of-lumber-go-down-home-sales-cost-update-march/>

³ Follow IRC requirements per Section R703.2 and manufacturer's installation instructions.

⁴ Always check local building codes to ensure you are properly addressing all requisites. This solution may not be applicable in seismic regions or those prone to high winds like coastal hurricane areas experiencing wind speeds of >110mph.

SCAN QR CODE FOR MORE INFORMATION

